

For a smarter finish to your new home or renovation, simply clad with **SmartClad!**

Only our traditional bevelback weatherboards have the unique **hidden fixing system.**



**SMART'CLAD™**  
The original hidden fixed weatherboards

# SmartClad, the smarter timber weatherboards – the only ones with the time-saving, unique hidden fixing system!



## SmartClad has revolutionised the installation of traditional bevelback timber weatherboards.

The safety pin, sliced bread, Velcro, and now **SmartClad** – the traditional timber weatherboard with the **hidden fixing system!** This amazing system provides the perfect finish to any new home or renovation and saves time in the process!

The **SmartClad** system was designed and developed by Purepine Mouldings Limited in Te Puke. Established in 1958, Purepine has been transformed from a small factory to a major complex now covering 7.5 hectares. Purepine sources only radiata pine logs from the Bay of Plenty and Waikato and processes them into over 130 different styles of mouldings.

**SmartClad**, their flagship product, is fast gaining reputation as first the choice of discerning builders throughout the country.

## It's what's going on behind, that makes **SmartClad** smarter from the front.

**SmartClad** are the new generation weatherboards, the tried-and-true traditional cladding, loved and used by New Zealanders for generations!

From the front they have the same clean profile, the same shadow lines. They are made only from our trusted sustainable timber source, **radiata pine** – not plastic, not composite! Only with **SmartClad** can you achieve a pristine finish, because there's no through-face fixing! There's no nailing, no puttying and no sanding. So it's no wonder they're smarter from the front!



## It's our unique hidden fixing system that makes **SmartClad** smarter from behind.

What you don't see, is what makes **SmartClad** weatherboards so radically different! It's all about a small plastic clip. The **SmartClip**, designed to revolutionise the way traditional timber weatherboards are installed.

The **SmartClip** is the unique patented fixing clip. This little clip is screwed into a groove at the head of each board to the stud. There, the **SmartClip** sits at exactly the right angle to ensure it holds the board above securely. It then simply slots into the specially designed receiver groove on the back of our weatherboards.

That's what makes **SmartClad** smarter from behind.

HIDDEN FIXING

Because there's no nailing, no puttying, and no face damage, **SmartClad** weatherboards **save installation time!**

Not only do you save time installing **SmartClad** weatherboards, but the painter also saves more time not having to arduously fill and fair each board prior to painting. **This means considerable time-saving all round!**



## **Smart** for re-cladding

**SmartClad is ideal for re-cladding existing homes** – particularly in instances such as where existing cladding has failed, “leaky homes” for instance, or weathertightness is an issue. As with conventional timber weatherboards, **SmartClad** allows the home to breathe. Home owners can have complete peace of mind regarding weathertightness.

In re-clad situations, where time is of the essence, **SmartClad** not only provides a considerable **time-saving advantage**, without any corner-cutting, you also get that timeless, clean-lined, pristine finish!

## Smart installation

The boards go up so quickly and easily, that proficient builders may **save up to 50% on normal labour time**. Once the starter board is correctly positioned, the others simply lock into place one after another, without the further need for stringlines. **Lightweight and easy to handle**, SmartClad weatherboards can be easily installed by one person.

## Smart finish

Because **there's no through-face fixing**, there's no potential for damage to the weatherboard. You **achieve a pristine finish without nailing, puttying or sanding**.

SmartClad weatherboards are 6 metres long, sealed with our custom coating and primed on four sides prior to leaving the factory. Like any timber product, it is important to keep SmartClad dry and under cover to prevent distortion and ensure a perfect finish.



### Smart System

SmartClad is more than just weatherboards, it's pre-shaped components create a **complete cladding system**, including our specially designed starter-boards that sit at the base of each wall, to accurately begin the cladding process, pre-shaped scribes and window facings and pre-shaped two-piece interlocking box corner sections.

### Smart Scribes

How long does it take to scribe an average-sized weatherboard home? A week? Imagine reducing that time to more like a day! Our **SmartClad** system is so accurate that there's no need for painstaking measuring and cutting of scribes or facings to fit. Our pre-shaped scribes do the job quickly and accurately. Just cut them to length and install.

### Smart Corners

SmartClad also makes it easier to create traditional box-corners and window facings. Our pre-shaped two-piece box corner facings save hours and create a perfect finish. Alternatively you can use our custom designed corner and joint soakers, for a more contemporary look. Or just use standard soakers.

L A T I O N T I M E

# The **SmartClad** hidden fixing system has changed the face of weatherboards for ever, with a **smarter finish!**

It doesn't matter whether you are building a new home, renovating an existing home or recladding a "leaky" home, remember, the **SmartClad** fixing system, using only traditional bevelled back timber weatherboards, gives you a **smarter finish right from the start!**



## **No more** nailing!

Because of our hidden fixing system, there's no through face nailing, there's no potential for damage to the weatherboards. If there's no nailing there's no nails to punch. This leaves you with a pristine board, just as it left the factory, sealed and primed, right from the start!

## **No more** puttying!

Therefore no painstaking filling and fairing thousands of nail holes. That means there's no sanding either, except in exceptional cases, such as around gables! And obviously you'll still need to conventionally nail the window facings and box corners!

## **No** face damage!

No through face nailing means no face damage! The boards remain in their original, sealed and primed, ready-to-paint factory-finished state. So much goes into **SmartClad** boards from the start, it's no wonder they give any home a smarter finish!

“I’m a fussy builder, so everything has to be just right. So I tested **SmartClad** on my own home before using it on my customers’ homes.

I wouldn’t go back to conventional weatherboards after using **SmartClad** on my own home. I achieved the clean finish that I wanted and saved a heap of time on the cladding section.”

Nathan Fell Building & Maintenance, Te Puke



## We believe in sustainability

We source all our logs from sustainable plantation forests found around the Bay of Plenty and Waikato and choose with great care to ensure they meet the specifications of the products required from them.

To be competitive as well as cost effective, optimising the timber to reduce wastage is vital. To this end we are using OptiCut technology to maximise the amount of timber we can use.

And elsewhere in the operation we use waste sawdust and shavings as bio fuel to produce heat for the kiln drying operation.

At Purepine Mouldings we adopt this eco-friendly attitude throughout all aspects of our production.



BETTER FINISH

# Here's the simple, 3 step, **time-saving** way to

**Installing SmartClad is the smart choice.** Three steps make it easy. Once you've ensured the starter boards are completely level, you can then proceed quickly and confidently to install rest of the weatherboards, without the need for string lines or levels. As an added accuracy check as you go, you can always use a piece of scribe as a storyboard.

## Step 1 Position the Starter Boards

**Correct alignment of the starter board is the key to a great job. Take time to position it as accurately as possible.**

Position the starter board so it overlaps the head of the foundation, or concrete base, by at least 50mm. Confirm exact level with a laser or string line.

For best results, nail the starter board to the bottom plate of the framing, 75mm-100mm up from the base of the board. This avoids any distortion to levels that may occur when screwing the initial **SmartClips** into place!

**QUICK TIP:** The success of the whole cladding process hinges on this crucial first step being correctly executed.

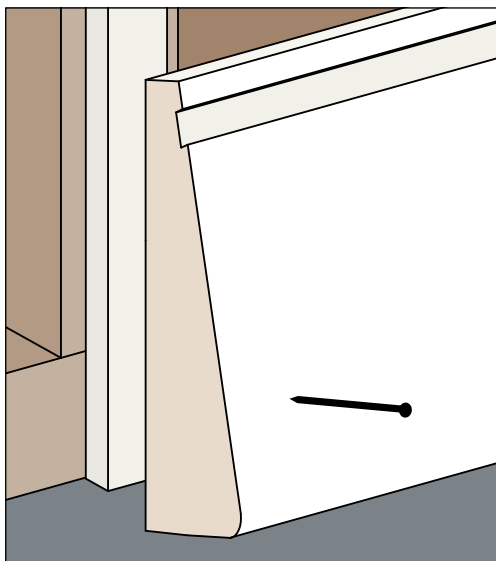

## Step 2 Add SmartClip to Starter Boards

Identify the stud nearest to the centre of the starter board. Fit a **SmartClip** into the angled rebate on the head of the starter board. Position clips in line with each stud/cavity batten. Make sure the **SmartClip** is angled upwards, and sits comfortably, horizontally along the groove.

Secure the **SmartClip** to the stud/cavity batten with a standard 65mm, 8 gauge, square head screw, using a downward action. The angle of the screw hole will help achieve this.

Work your way along the starter board, firmly securing the board with **SmartClips** as you go.

**QUICK TIP:** Do not over-tighten the screws, or you may distort the profile of the **SmartClip**.



# install **SmartClad** timber weatherboards!

**SmartClad is so accurate.** Our window scribes, window facings and 2-piece interlocking corners are all pre-shaped as part of our system. This further increases the speed by which **SmartClad** can be installed. These components are 6 metres long. You simply cut them to the required length and fix into place in the conventional fashion.

## Step 3 Apply each weatherboard

Fit the specially designed angled groove on the reverse of the **SmartClad** weatherboards, over the **SmartClips** along the length of the starter board. Seat firmly with downward pressure. The board will sit in place with very little effort while you prepare to secure it. Using the same procedure as fitting the starter board, secure each weatherboard, from the centre stud, until the area to be clad is completed.

**QUICK TIP:** To further increase speed of board installation, pre-cut an entire wall length of boards, particularly if you are working from scaffolding. Alternatively, have someone cutting while you are applying.

## Note Seating boards correctly

If a board is not seating correctly, gently nudge the bottom of the board in an upward motion with the ball of the hand. Then push in and down to seat properly.

**DO NOT FORCE** or hit the face of the board as you will damage the **SmartClip** and "receiver groove" on the rear of the weatherboard.

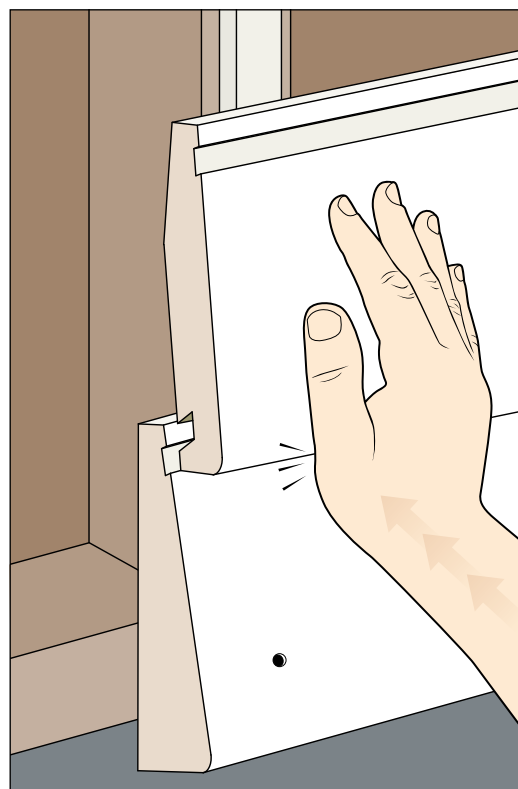
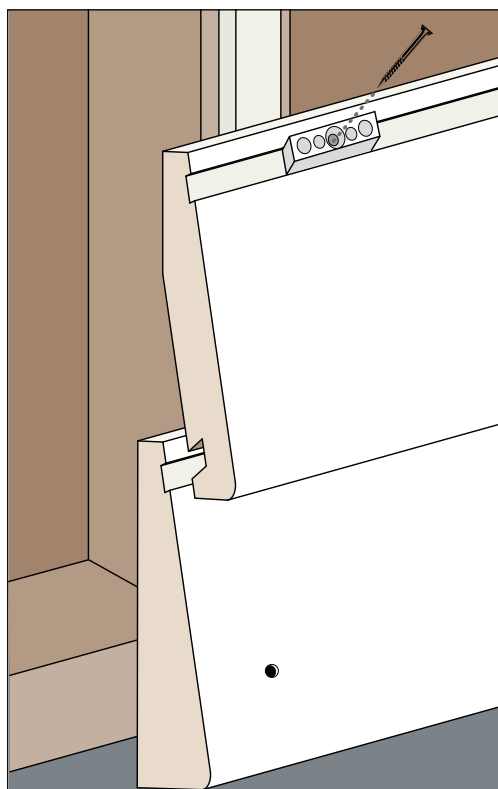

# SmartClad has pre-shaped components

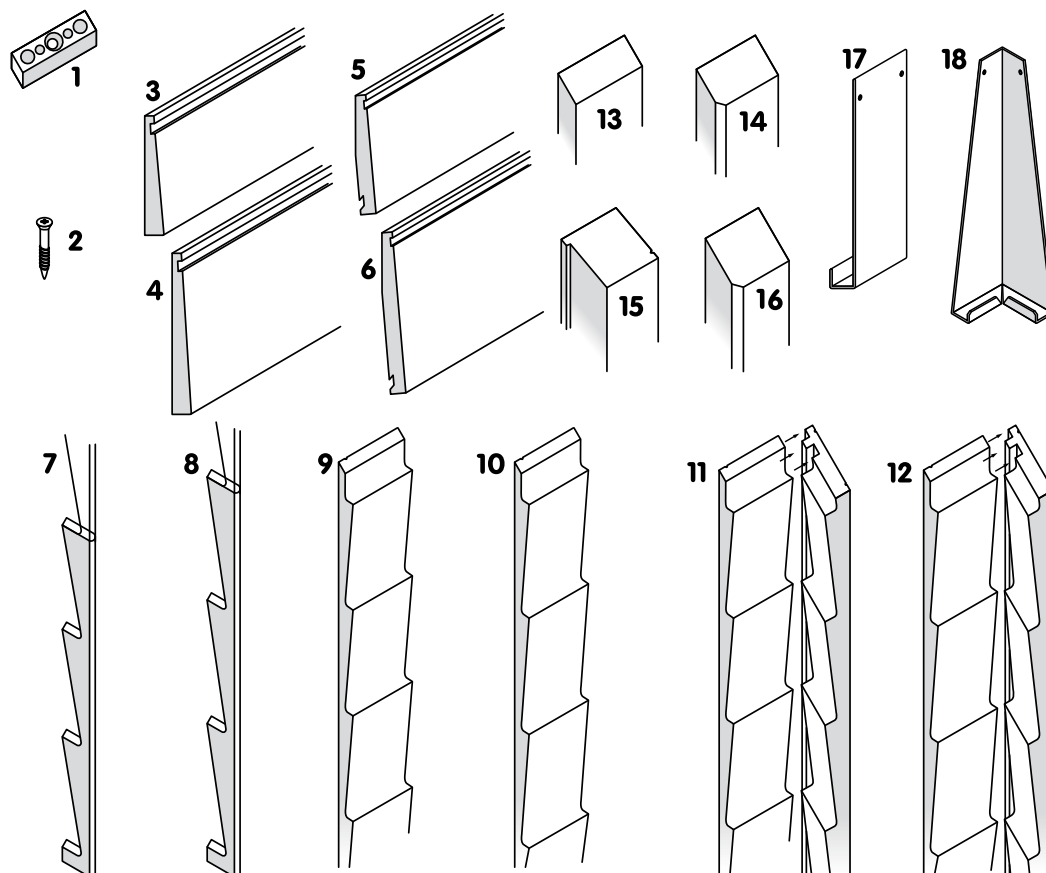

	Product	Code	Size	Length
1	SmartClip 500 per box	SC	40mm x 18mm	
2	SmartClad Screws 500 per box	SS	8 Gauge	65mm
3	Starter Board	SSB140	140mm x 30mm	6.0 metres
4	Starter Board	SSB185	185mm x 30mm	6.0 metres
5	Bevelback Weatherboard	SWB140	140mm x 18mm	6.0 metres
6	Bevelback Weatherboard	SWB185	185mm x 18mm	6.0 metres
7	Pre-shaped Scriber	SPS140/10 SPS140/18	40mm x 10mm 40mm x 18mm	5.4 metres 5.4 metres
8	Pre-shaped Scriber	SPS185/10 SPS185/18	40mm x 10mm 40mm x 18mm	5.4 metres 5.4 metres
9	Pre-shaped Facing	SPF140	88mm x 34mm	5.4 metres
10	Pre-shaped Facing	SPF185	88mm x 34mm	5.4 metres
11	Pre-shaped Box Corner (2 Piece)	SPBC140/80 SPBC140/88	80mm x 34mm 88mm x 34mm	5.4 metres 5.4 metres
12	Pre-shaped Box Corner (2 Piece)	SPBC185/80 SPBC185/88	80mm x 34mm 88mm x 34mm	5.4 metres 5.4 metres
13	Cavity Batten	SCB	45mm x 21mm	5.4 metres
14	Eaves Moulding	SEM	40mm x 27mm	5.4 metres
15	Beazley Sill	SBS	40mm x 38mm	5.4 metres
16	Internal Corner	SICS	36mm x 36mm	5.4 metres

	Product	Code	Product	Code
17	Flat Soaker Galvanised Flat Soaker Stainless	FSG FSS	18	Corner Soaker Galvanised Corner Soaker Stainless
				CSG CSS

# Useful **tips** for a better job!

For a superior project, **do not rush**, you will save time anyway!  
This is the best tip that we've learned from on-site professionals.  
So here are some more we've learnt while developing **SmartClad**.

- 1 **Make sure the SmartClip** fits snugly into the receiver groove at all times.
- 2 **Keep the fixing screw angle the same** as the hole in the SmartClip.
- 3 **Work your way along board**, from one end, securing the SmartClips as you go (you are straightening the timber as you go because your starter board is installed straight and level).
- 8 **If using boxed corners**, finish the first board flush with the wall end. The second board should be finished at the outside of the first board and bevelled back at the same angle as the weatherboard. This eliminates the hole at the bottom corner.
- 9 **You will save time** and find it is easier to clad the wall before windows are installed.



- 4 **Short board lengths** can creep more than the longer runs. Make sure you reference the short runs to other walls to keep them in line.
- 5 **Some face nailing** will be required around gables etc, where it is difficult to achieve the downward angle of the screw. Don't be afraid to face nail in the traditional manner (10mm above the lap of the board underneath).  
You will still achieve a superior finish and save time, because nailing will be kept to a minimum.
- 6 **Install a face nail** on each end of the board 10mm above the lap of the board in a place where the soaker, facing or box corner will cover the board.  
This additional fixing is an easy insurance against any potential movement in the timber as a result of cutting the ends of the timber and reducing the seal.
- 7 **Pre-shaped scribes, corners and facings** may need a final fitting before being applied. By using the pre-shaped scribe as a story board, there should be minimal cutting and altering of the scribe needed.

## Painting

- 1 **Always liberally prime cut ends** – more paint will help seal the timber from moisture uptake, thereby reducing dimensional movement.
- 2 **Ensure two coats** of high quality acrylic top coat are applied at a minimum wet film thickness of 80 microns per coat. More paint applied will aid the performance over time.
- 3 **Because SmartClad is sealed** prior to priming, moisture from the paint will not be absorbed into the timber as it normally would. This means that the paint will take longer to fully cure.  
The surface will cure first and possibly leave the appearance of water marks beneath the surface. This will take time to fully cure. Be patient and these watermarks will disappear.  
The time it takes will depend on weather conditions but it could take up to a month. Watering down the paint will slow the drying process.

# And here are your questions, answered!

## What is SmartClad?

SmartClad is a **hidden fixing system** for traditional timber weatherboards.

## What kind of weatherboards?

The traditional radiata pine bevelled back profile, produced in New Zealand resource for over 80 years.

## Why should I use this system?

To save time, effort and money when installing timber weatherboards.

## What are the main benefits of the SmartClad system?

- No drilling
- No nailing
- No puttying
- No face damage.

## What makes the system special?

The weatherboard fixing is hidden behind the boards.

## Who invented it?

Jeff Tanner, co-owner of Purepine Mouldings Limited, Te Puke New Zealand

## Is it easy to use?

Yes. There are only 3 simple steps.

## Can anyone use the system?

Yes. Professional builders prefer it, and DIY builders have no problems using it.

## Will it save me time?

Yes. It has been estimated that proficient builders may save up to 50% application time compared with traditional weatherboard installation.

## Can I use it by myself?

Yes of course, although an extra pair of hands will naturally make life easier.

## Is it suitable for recladding existing homes?

It's ideal! The speed of installation makes it the most appropriate choice.

## What else comes in the system?

Pre-formed window facings, scribes and corners, so the installer doesn't have to laboriously cut them to fit, just to length.

## Are the boards primed?

Yes, front, back and edges.

## Is puttying required?

Not on the weatherboards because there is no through face fixing.

## What about finishing?

The painter will need to give a light sand just to key the paint, as is normal.

## Is SmartClad expensive?

No. The system is no more expensive than any other weatherboards. Just better!

## What makes it unique?

A little plastic clip, the **SmartClip**.

## How is it unique?

The fixing is unseen, so doesn't damage the front face of the board. It has a range of ready-made components.

## How does it work?

See the simple time-saving instructions on pages 8 and 9.

## Is the system accurate?

Yes. The system has been designed so all the components fit neatly together like a jigsaw.

## Does this system apply to all weatherboards?

No. Only **SmartClad** weatherboards have this unique system.

## Is it patented?

Yes, in New Zealand and internationally.

## Does the company have an eco-friendly policy?

Yes. The logs for all Purepine Mouldings products are produced from renewable New Zealand radiata pine. Raw logs are made into **SmartClad** weatherboards and over 130 product lines. Residual waste, even sawdust, is converted into energy to help fuel the factory. The on-site processing is so clean, there is virtually no carbon emission.

## Where can I buy SmartClad?

From approved timber merchants and regular building supply companies.



For more information contact Purepine Mouldings Limited  
Call freephone **0800 768 253**  
Visit our website **www.smartclad.co.nz**  
See our display in the Auckland Home Ideas Centre

**SMARTCLAD**<sup>TM</sup>  
The original hidden fixed weatherboards